

- |                               |                                    |
|-------------------------------|------------------------------------|
| 1) Function Select Switch     | 8) Urgent Switch                   |
| 2) Gas / Vacuum Timer         | 9) Pedal switch                    |
| 3) Power Main Switch          | 10) Power Plug                     |
| 4) Congealing Indication Lamp | 11) Silencer                       |
| 5) Sealing Indication Lamp    | 12) Air/Gas Inlet                  |
| 6) Congealing Timer Knob      | 13) Pressure Setting<br>Knob/Gauge |
| 7) Sealing Timer Knob         | 14) Nozzles                        |

## 2. SET UP INSTRUCTION

1. After unpacking your sealer. Place the unit on a level and stable surface.  
WHEN YOU OPENED YOUR CARTON YOU SHOULD HAVE FOUND THE FOLLOWING:  
\*Vacuum sealer \*Operation manual  
\*Spare parts kit. (Working table, Silencer, Heating wire, Fuse, Pedal switch, 5/32 Allen wrench, Rubber pad)
2. Connect power plug to AC outlet and connect the Pedal Switch to the outlet.
3. Connect a clean filtered air supply to the AIR INLET and put the Silencer into EXHAUST. Air consumption 7.8 SCFM (220L-per min), 78 PSI (5.5 Kg/cm<sup>2</sup>).
4. \*If VG series connect a Gas Regulator and Flushing supply to the GAS INLET.
5. Put the Working table to the sealer.
6. Turn on the Main Switch to ON position. A Yellow indicator light will turn on.
7. You are now ready to begin sealing.

## 3. OPERATING INSTRUCTIONS

1. Once all your connections (air and electrical) are made, you are ready to begin.
2. Turn on Main Switch. Yellow light appears, indicating power to the unit.
3. Program pressure settings  
\*Set 28 PSI (2 Kg/ cm<sup>2</sup>) for low pressure.  
\*Set at 78 PSI (5.5 Kg/ cm<sup>2</sup>) for high pressure.
4. Select the Gas/Vacuum Switch according to your packing needed then set the Gas/Vacuum Timer.  
\*GAS program for Timer1 (vacuum) to Timer2 (gas)  
\* VACUUM program for Timer1 (gas) to Timer2 (vacuum)
5. Adjust the Sealing Knob and Congealing Knob, according to bag thickness.
6. With bag open, position the bag onto Seal Bar with Nozzles as far as it will extend.
7. To operate unit, step on Pedal Switch, Sealing Jaws will close. Vacuum /Gas will begin and then be followed by sealing and cooling. The jaws will open automatically when cycle is completed and you can remove the sealed Package and begin the cycle anew.

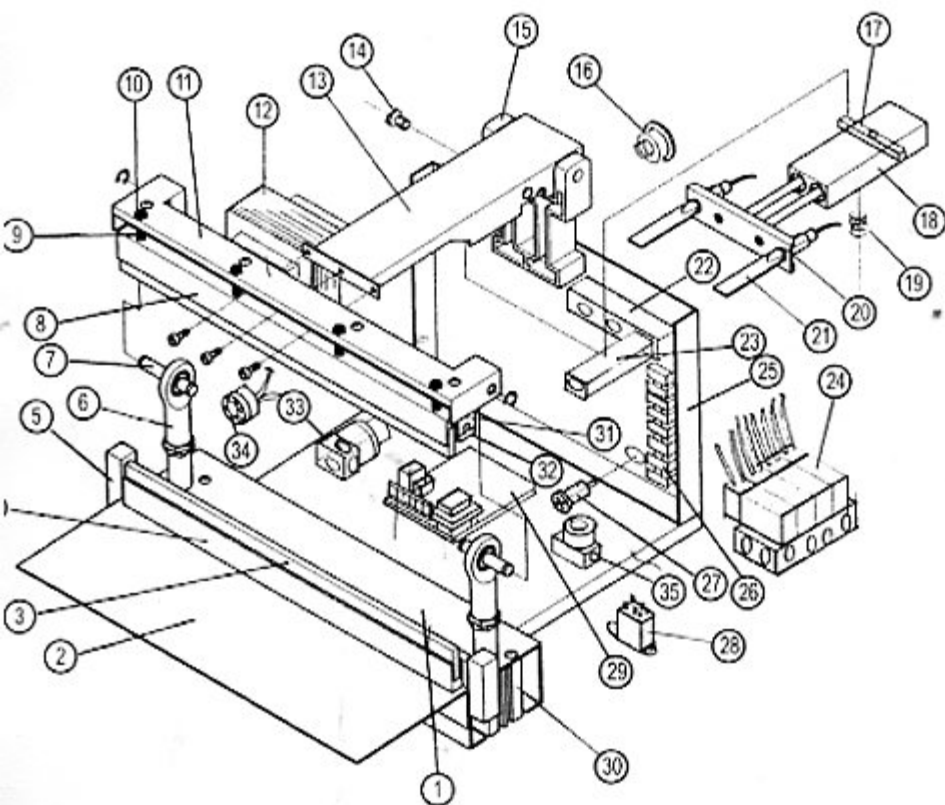

## 5. PARTS LISTS

- |                               |                                    |
|-------------------------------|------------------------------------|
| 1) Jaw Base                   | 19) Spring For Nozzle<br>Pneumatic |
| 2) Working Table              | 20) Nozzle Bracket                 |
| 3) Rubble Pad For Vacuum      | 21) Nozzle.                        |
| 4) Low Teflon Fixed Plate     | 22) Exhaust Bracket                |
| 5) Heater Element Attachment  | 23) Single Stage Pumps             |
| 6) Connect Poles              | 24) Valve Set                      |
| 7) Bolt Pin                   | 25) Back Plate                     |
| 8) Upper Rubble Holder        | 26) Terminal Block                 |
| 9) Spring For Rubble Holder   | 27) Fuse holder                    |
| 10) Bolt Flange               | 28) Relay                          |
| 11) Upper Jaw Plate           | 29) Control PCB                    |
| 12) Heater Transformer        | 30) Jaw Pneumatic                  |
| 13) Pressing Plate            | 31) Upper Jaw                      |
| 14) Screw For Pneumatic       | 32) Sealing Rubble                 |
| 15) Hinge Bracket             | 33) Pressure Regulator             |
| 16) Pressure Gauge            | 34) Timer Socket                   |
| 17) Bolt For Nozzle Pneumatic | 35) Gas Valve                      |
| 18) Nozzle Pneumatic          |                                    |

## 6. CAUTIONARY MARKING

### CAUTION

- 1) To reduce the risk of shock, disconnect the unit from the supply circuit before servicing the replacement of the heating element.
- 2) To provide continued protection against risk of electric shock, connect to properly grounded outlet only.

### WARNING

- 1) A live heating element is located in the arm under the Teflon tape. Use caution during operation. **DO NOT TOUCH THE ELEMENT.**
- 2) For Continued Protection Against Fire or Electric shock, Replace Only With Type Cartridge and 10 Ampere Fuse, provided in legible adjacent to fuse holder.

## 7. ELECTRIC CONNECTION DIAGRAM

### 1) VG series

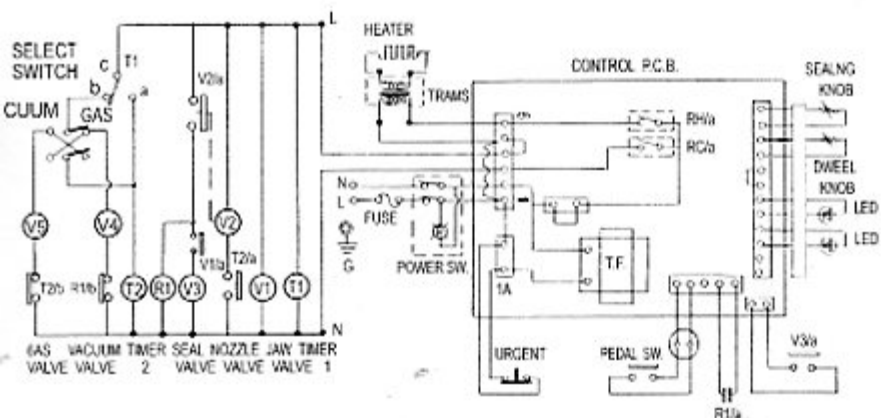

### 2) VA series

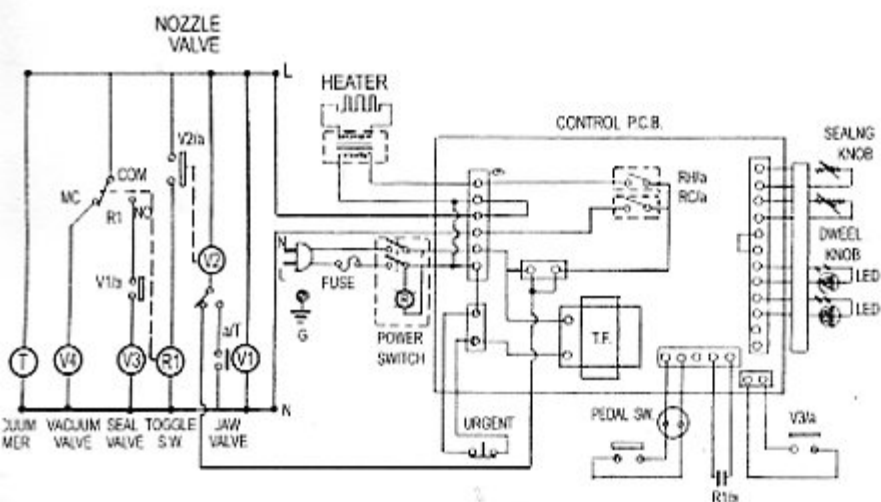

## 8. CHANGING PARTS

To replace burnt out Teflon tape or broken element wire please follow these instruction:

### REMOVE PLUG FROM ELECTRIC OUTLET USE ONLY GENUINE REPLACEMENT PARTS

1. To replace Teflon
  - a) Remove low Teflon fixed plate. Loosen Teflon clips.
  - b) Pull out Teflon tape just enough to cut off burned area. Smooth out Teflon and re-fix the Teflon fixed plate.
  - c) Rotate Teflon screw to pull Teflon tight. Retighten the Teflon clips.
2. Replacing heating element wire
  - a) Loosen Teflon clips. Remove the low Teflon fixed plate.\*
  - b) Lift up Teflon and remove broken element wire from heater poles. (Heater Element Attachment).
  - c) Put new element wire on heater poles. Do not bend or crimp the wire.
  - d) Replace Teflon and Teflon fixed plate. Tighten Teflon with Teflon screw. Tighten Teflon clips.

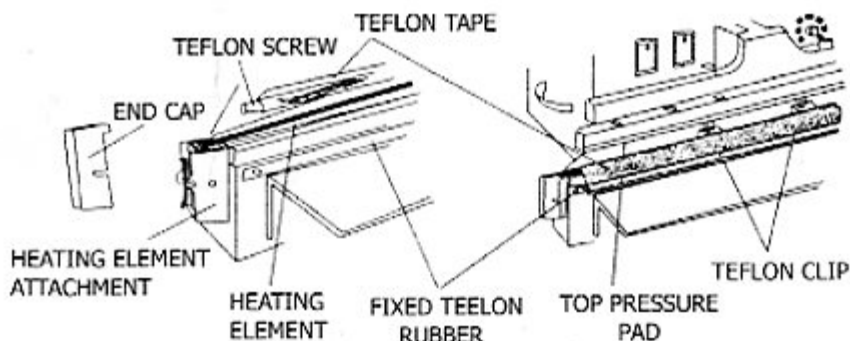

MODEL	455VG/VGD	4510VG/VGD	605VG/VGD	6010VG/VGD
Max. Seal Length	450mm (18")	450mm (18")	600mm (24")	600mm (24")
Seal Width	5mm	10mm	5mm	10mm
Vacuum Level	635mm Hg (25")	635mm Hg (25")	635mm Hg (25")	635mm Hg (25")
Seals/Vacuum Time	0-30sec	0-30sec	0-30sec	0-30sec
Heat Time	0.2-2.5sec	0.2-2.5sec	0.2-2.5sec	0.2-2.5sec
Swell Time	1-8sec	1-8sec	1-8sec	1-8sec
Max. Seal Thickness	2x0.15mm/0.4mm	2x0.15mm/0.4mm	2x0.15mm/0.4mm	2x0.15mm/0.4mm
Watts	1100W/1800W	1500W/2400W	1400W/2200W	1900W/2800W
Weight	23Kg/25Kg	27Kg/29Kg	25Kg/27Kg	29Kg/31Kg

VG and VA is same specification, VGD and VAD is same specification.

## 10. SPARE PARTS

ACCESSORIES	Q'TY
Heating wire	VAX2 or VAD (Upper Wire) x1, (Lower Wire) x1
Fuse	10Ax1 or 20Ax1

Spare parts kit: Working table, Silencer, Pedal switch, 5/32 Allen wrench, Rubber pad, as Regulator (VG type).

## 11. HELPFUL INFORMATIC

Always keep the sealing platform clean. Particular care "should" be taken to remove any residue from the Teflon tape.

Do not clean the sealing platform with anything wet.

Make sure to change the upper Teflon tape (above the element wire) and the lower Teflon strip (below the element wire) when they become worn. If this is not done the element wire may short out and become damaged.

When replacing the heating element always check the condition of the bottom Teflon tape. It is important that you replace the element wire only with the one made for this machine. You can damage the transformer with the wrong element wire.

Occasionally check the condition of the top pressure pad (silicon rubber) for wear or burn. A poor rubber pad will effect on the quality of your seal.

**VACUUM SEALERS (NOZZLE TYPE)**  
455VA, 4510VA, 605VA, 6010VA  
455VG, 4510VG, 605VG, 6010VG  
VAD AND VGD SERIES  
INSTRUCTION

